

**Modular Preparation**  
**Heated plate lowerator with 2 cylinders,**  
**adjustable plate diam. 200-280mm,**  
**beechwood finish**

ITEM # \_\_\_\_\_

MODEL # \_\_\_\_\_

NAME # \_\_\_\_\_

SIS # \_\_\_\_\_

AIA # \_\_\_\_\_

**321013 (FSLHPL)**

 Heated Plate Lowerator with  
 2 cylinders, adjustable Plate  
 diam. 200-280mm,  
 beechwood finish

### Short Form Specification

Item No. \_\_\_\_\_

304 AISI stainless steel worktop with rounded edges. Two heated cylinders (+30/+50°C) able to accommodate up to 50 plates (adjustable plate diam. 200-280mm). Side panels in beech wood finishing. Tray slides in 304 AISI stainless steel, mounted on both sides of the unit, fold down in order to facilitate passage of the unit through doorways. The unit is mounted on 4 wheels (150mm high).

### Main Features

- Lifting springs allow plates of different weights to be stacked.
- Plate lowerator suitable to warm, transport and distribute plates.
- Set temperature for heated models +30/+50°C.
- The two tray slides are constructed in plain 304 AISI stainless steel and can be folded down to facilitate passage of the units through doorways.
- Two cylinder plate lowerators, each cylinder can hold 50 plates with a diameter from 200 to 280 mm.

### Construction

- Unit mounted on four wheels, 150 mm in height (two with brakes), but can be mounted on 150 mm high feet (as special).

### Optional Accessories

- TRAY SLIDE GABLE 1060X200 PNC 852042 ☐
- ADJUSTABLE LEG, MARINE PNC 852064 ☐
- S/S TRAY SLIDER 450MM-WIDTH 200-270MM PNC 852067 ☐
- S/S TRAY SLIDER 450MM-WIDTH 280-300MM PNC 852073 ☐
- OTHER LAMINATE COLOURS FOR UNITS 450MM PNC 852132 ☐

APPROVAL: \_\_\_\_\_



**Electrolux**  
PROFESSIONAL

**Modular Preparation**  
Heated plate lowerator with 2 cylinders,  
adjustable plate diam. 200-280mm, beechwood  
finish

Front

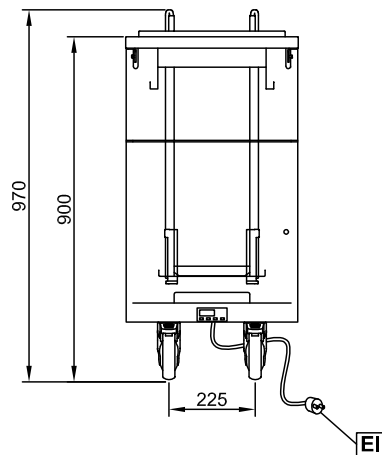

Side

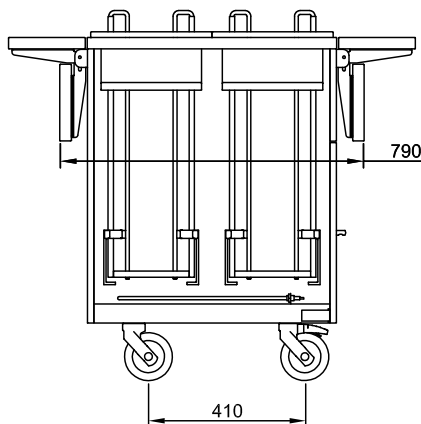

EI = Electrical inlet (power)

Top

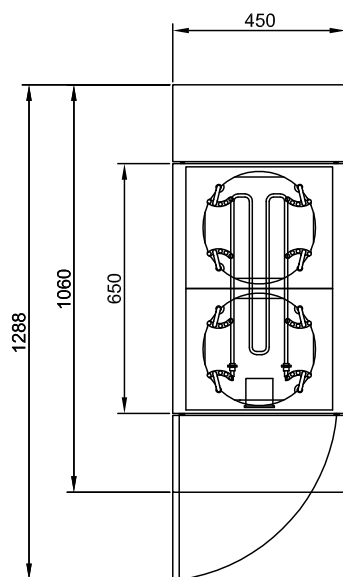

### Electric

Supply voltage:

321013 (FSLHPL)

230 V/1 ph/50/60 Hz

Total Watts:

0.7 kW

### Key Information:

External dimensions, Width: 450 mm

External dimensions, Depth: 1060 mm

External dimensions, Height: 900 mm

Net weight: 45 kg



**Modular Preparation**  
Heated plate lowerator with 2 cylinders, adjustable plate diam.  
200-280mm, beechwood finish  
The company reserves the right to make modifications to the products  
without prior notice. All information correct at time of printing.

2024.10.18