

## Digital Undercounter Freezer Counter - 2 Door+2 1/2 drawer (R290)

ITEM # \_\_\_\_\_

MODEL # \_\_\_\_\_

NAME # \_\_\_\_\_

SIS # \_\_\_\_\_

AIA # \_\_\_\_\_

**710404 (EJ3KBAAB)**

 2-door and 2-drawer  
Freezer Counter, -22-15°C,  
AISI 304 (R290)

### Short Form Specification

#### Item No. \_\_\_\_\_

AISI 304 stainless steel panels, AISI 430 bottom panel, galvanized back panel. Worktop thickness 50mm. N. 2 full doors and N. 2X1/2 drawers. Built-in refrigeration unit. Automatic defrost. Operating temperature: -15-22°C. R290 gas in refrigeration circuit. Supplied with 1 grid for each door compartment

### Main Features

- Small footprint to fit even in limited environments.
- Anti-tilt runners accept GN 1/1 containers.
- Refrigerated compartment designed to accept GN 1/1 containers.
- Mounted on stainless steel feet to give 150 mm (-5/+50 mm) clearance for ease of cleaning the floor.
- Digital control panel.
- Certified safety CE requirements.
- Preservation performances and temperature uniformity within the cell guaranteed at 5-HEAVY DUTY (40°C) working conditions according to EN16825:2016 test protocol.
- Hot gas automatic evaporation of defrost water.
- Frontal and easy access to all components in the cooling unit.
- Fully compliant HACCP digital control: when temperature exceeds critical limits, acoustic and visual alarms are activated. Up to two months of event are kept in memory.
- Self closing stainless steel doors (< 90°).
- Combination of doors and drawers to suit any configuration needed, with the possibility to change the configuration on site. Right cooling unit available on request.
- 0mm clearance installation space: tower configuration cooling unit guarantee performance with frontal ventilation only; this unique solution allows installation against the wall or side by side with other appliances, even on the cooling unit side to maximize the use of kitchen space.
- Prearranged to fit RS485 port to facilitate connection to a remote computer and integrated HACCP systems.
- Combination of doors and drawers to suit varying needs, with the possibility to change the configuration on site.
- Forced air circulation for rapid cooling and an even temperature distribution.
- External bottom panel in stainless steel.
- Equipped with forced air circulation system for rapid cooling and temperature distribution within the cell.
- Digital control panel with temperature display.
- External back panel in galvanized steel.
- Freezer compartment designed to accept GN1/1 containers.
- Adjustable temperature range from -15°C to -22°C.
- Connectivity ready for real time access to connected appliances from remote and data monitoring (requires optional accessory).
- Easy serviceability thanks to the intuitive control panel with access via app.
- Integrated RS485 port to facilitate connection to a remote computer and integrated HACCP systems.
- Tropicalized unit.

### Construction

- Fault code display.
- Developed and produced in ISO 9001 and ISO

APPROVAL: \_\_\_\_\_

- 14001 certified factory.
- Extractable cooling unit to facilitate maintenance.
- Ease of cleaning and high hygiene standards thanks to the rounded internal corners, the easily removable runners, grids and air conveyors.
- Built-in refrigeration unit.
- Pre-arranged for drain-pipe.
- Internal and external doors, front, back and side panels in AISI 304 Stainless steel.
- Interior base with rounded corners, pressed from a single sheet.
- IP21 protection index.
- Internal structure with 15 charging positions (3 cm pitch) available to host GN 1/1 grids, ensuring higher net capacity and a greater storage space.
- Built-in compressor to suit operating conditions.
- Access to all components from the front.
- Rounded internal corners for ease of cleaning.
- Mounted on Stainless steel adjustable legs to give 150 mm clearance for ease of cleaning.
- Internal and external doors, front and side panels and removable worktop in AISI 304 Stainless steel.
- Worktop in AISI 304 Stainless steel with a 50 mm profile.
- Anti-drip profile on stainless steel worktop edge.
- If needed, working top can be removed for easier handling during installation (in case of narrow doors).
- Excellent space optimisation thanks to the compact dimensions.
- External back panel in galvanized steel.

- Kit 4 (45mm) spacers for wheels for refrigerator/freezer counters

PNC 881277



## Sustainability



- Removable triple-chamber balloon magnetic gasket to improve insulation and reduce energy consumption and ease of cleaning.
- Fitted with 90 mm thickness of cyclopentane insulation for best insulating performance (thermal conductivity: 0,020 W/m\*K) and lowest environmental impact (GWP=3).
- CFC and HCFC free, highly ecological refrigerant type: R290 (ecological gas in foam: cyclopentane). Hydrocarbon refrigerant gas R290 for the lowest environmental impact (GWP=3), to reduce green house and ozone depletion effects.

## Included Accessories

- 2 of Kit 1/1 grey rilsan grid and 2 side runners for refrigerated counters PNC 881109

## Optional Accessories

- 1/1GN grey rilsan grid for refrigerated counters PNC 881107 ☐
- 2 side runners for 1/1 GN ecostore refrigerated counters PNC 881108 ☐
- Kit 1/1 grey rilsan grid and 2 side runners for refrigerated counters PNC 881109 ☐
- 1/1 GN plastic container, H=65 mm PNC 881110 ☐
- 1/1 GN plastic container, H=100 mm PNC 881111 ☐
- 2x½ drawer kit for refrigerated counters - h650mm PNC 881176 ☐
- Lock for refrigerator/freezer counters with 3 compartments - h650mm (can be used in kit for Marine conversion) PNC 881246 ☐

Front

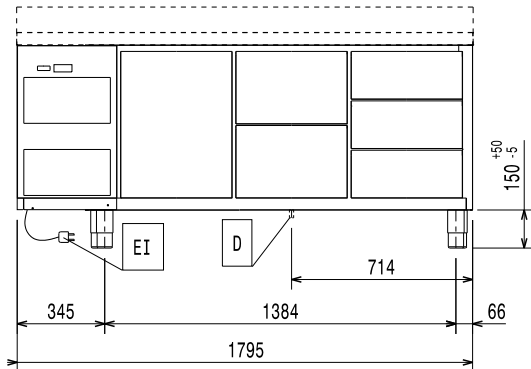

Side

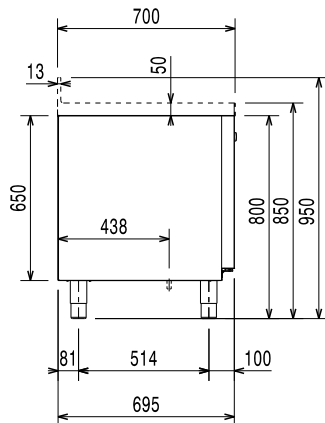

EI = Electrical inlet (power)

Top

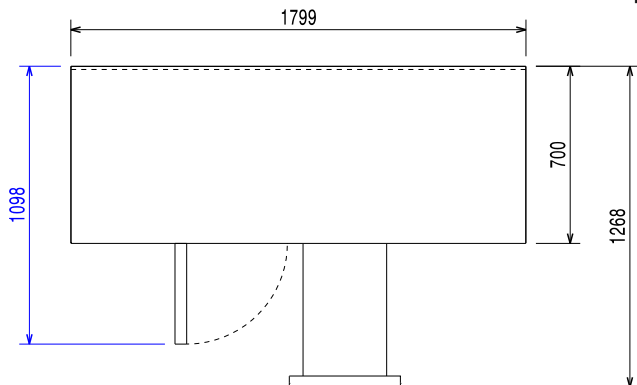

## Electric

Supply voltage:

710404 (EJ3KBAAB)

220-240 V/1 ph/50 Hz

Electrical power max.:

0.49 kW

## Key Information:

Gross capacity:

Net Volume:

215 lt

N° of doors:

External dimensions, Width:

1799 mm

External dimensions, Depth:

700 mm

External dimensions, Height:

850 mm

Internal Dimensions, Width:

1252 mm

Internal Dimensions, Depth:

560 mm

Internal Dimensions, Height:

550 mm

Net weight:

130 kg

Shipping volume:

1.44 m³

Depth with doors open:

1110 mm

## Refrigeration Data

Control type:

Digital

Compressor power:

Min/Max internal humidity:

Operating temperature min.:

-15 °C

Operating temperature max.:

-22 °C

Operating mode:

Ventilated

## ISO Certificates

ISO Standards:

ISO 9001; ISO 14001; ISO 45001; ISO 50001

## Sustainability

Energy Class (EU Reg. 2015/1094):

D

Yearly and daily energy consumption (EU Reg. 2015/1094):

2500kWh/year - 7kWh/24h

Climate class (EU Reg. 2015/1094):

Normal duty (cl.4)

Energy Efficiency Index-EEI (EU Reg. 2015/1094):

68,76

Refrigerant type:

R290

GWP Index:

3

Refrigeration power:

569 W

Refrigerant weight:

140 g



**Electrolux**  
PROFESSIONAL

## Digital Undercounter Freezer Counter - 2 Door+2 1/2 drawer (R290)

### EU energy labelling from 1st July 2016

The European energy labelling scheme for professional refrigerators and freezers is based on requirements setting Minimum Energy Performance standards for commercial refrigeration cabinets sold within the EU.

These requirements are designed to drive energy efficiency and environmentally friendly approach for professionals. The European energy labelling scheme will apply to all manufacturers and importers who sell and market products within the EU and it is mandatory across Europe. Important: all products which consume energy above the minimum level will not be able to be sold within the EU from 1 July 2016.

SI 2020 No. 1528.

Important: all products which consume energy above the minimum level will not be able to be sold within the EU from 1 July 2016.

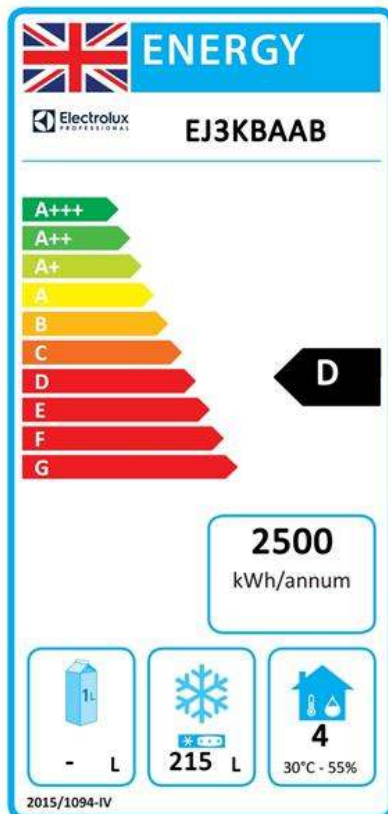
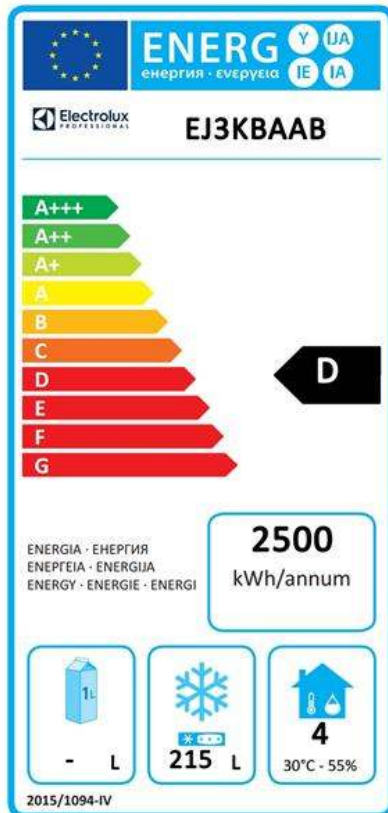

Digital Undercounter  
Freezer Counter - 2 Door+2 1/2 drawer (R290)

The company reserves the right to make modifications to the products without prior notice. All information correct at time of printing.

2024.11.06